

QUEBEC

AERODROME / FACILITY DIRECTORY

CHICOUTIMI / ST-HONORÉ QC

CYRC

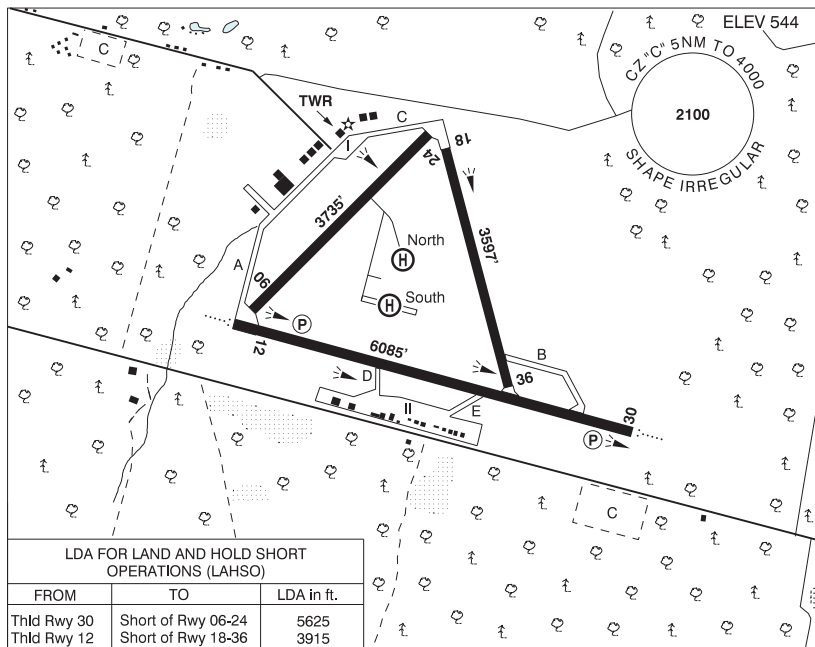

REF	N48 31 15 W71 03 02 1.5ESE 17°W (2013) UTC-5(4) Elev 544' A5010 LO7 HI5 HI6 CAP
OPR	Ministère des transports et de la mobilité durable 418-673-4245 (Administration), 418-812-4524 (Maint) Cert
PF	B-1,2,7 D-3,4,5,6
FLT PLN	(bil)
FIG	Québec 866-GOMÉTÉO or 866-WXBRIEF (Toll free within Canada) or 866-541-4105 (Toll free within Canada & USA)
ACC	Montréal 800-633-1353
WX	LWIS H24 LAWO 1300-0130Z†; 13-03Z† Mon-Fri 1300-0130Z† Sat-Sun Oct 15-Nov 16 and Feb 15-Mar 2. WxCam
SERVICES	
FUEL	100LL, JA
OIL	All
S	1,2,3,4,5,6,7
PVT ADV	Exact Air/Petro T 129.15 418-673-3522; AirMédic 13-22Z† 418-673-3838 O/T 418-718-5648 call out chgs.
RWY DATA	Rwy 12(122°)/30(302°) 6085x150 ASPH Rwy 06(062°)/24(242°) 3735x148 ASPH Rwy 18(182°)/36(002°) 3597x148 ASPH Poor drainage may cause hydroplaning.
RWY CERT	Rwy 12/30 AGN III B Rwy 06/24 AGN II Rwy 18/36 AGN II
RCR	Opr 12-03Z† Mon-Fri 12-24Z† Sat-Sun CRFI Rwy 06/24 no win maint.

QUEBEC

AERODROME / FACILITY DIRECTORY

CHICOUTIMI / ST-HONORÉ QC (Cont'd)

CYRC

HELI DATA	North: TLOF 65' x 65' ASPH South: TLOF 65' x 820' ASPH
LIGHTING	12-AO(TE ME) P2, 30-AO(TE ME) P2, 18-(TE ME), 36-(TE ME) ARCAL-118.4 type K
COMM	(bil)
ATIS	(English) 134.8; (French) 124.95
CLNC DEL	Prior to dep pilots must ctc Bagotville Tml for IFR clnc at 888-813-8508 when TWR clsd.
GND	St-Honoré 121.9 1300-0130Z†; 13-03Z† Mon-Fri 1300-0130Z† Sat-Sun Oct 15-Nov 16 and Feb 15-Mar 2.
TWR	St-Honoré 118.4 (V) 1300-0130Z†; 13-03Z† Mon-Fri 1300-0130Z† Sat-Sun Oct 15-Nov 16 and Feb 15-Mar 2. (emerg only 418-673-4353)
ATF	tfc 118.4 0130-1300Z†; 03-13Z† Mon-Fri 0130-1300Z† Sat-Sun Oct 15-Nov 16 and Feb 15-Mar 2. 5NM shape irregular 4000 ASL
TML	Bagotville 127.2 227.6
VFR ADV	Bagotville Tml 121.2
PRO	Itinerant tfc: See Bagotville VTTC. Training zone: Arrival & departure tracks see VTTC. Arrivals: Single engine: Minimum alt 2000 ASL. Helicopters: Maximum alt 1000 ASL within 2.5NM of A/D. (see Heli VTTC). Others: Minimum alt 2500 ASL. Right hand circuits runways 06, 12 and 36 (CAR 602.96)
HELI	Arrivals & departures: Maximum alt 1000 ASL btwn A/D & checkpoints. Departures: All heli must ctc gnd ctl. Checkpoints: JOLI (2NM E) arr/dep hdg 274°/094°. MARTEL (2NM NW) arr/dep hdg 154°/334°. MADOC (1.4NM SW) arr/dep hdg 024°/204°. SILO (2NM N) arr/dep hdg 169°/349°. HELIPAD RESTRICTIONS: North and South helipads avbl only with written authorization from Opr (CAR 602.96 (3)(d)). North and South helipads avbl only during TWR hr of ops (CAR 602.96 (3)(d)).
CAUTION	Training: Hvy tng W of the apt fr W bdry of CZ to St-Augustin (freq 123.4). Blasting: Blasting area 0.54NM radius N48 28 38 W071 06 46 (aprx 3.6NM SW A/D) sfc to 3800 ASL. Blasting area 0.54NM radius N48 28 41 W071 05 41 (aprx 3.1NM SW A/D) sfc to 3800 ASL.