

SASKATCHEWAN

AERODROME / FACILITY DIRECTORY

KIPLING SK

CKD5

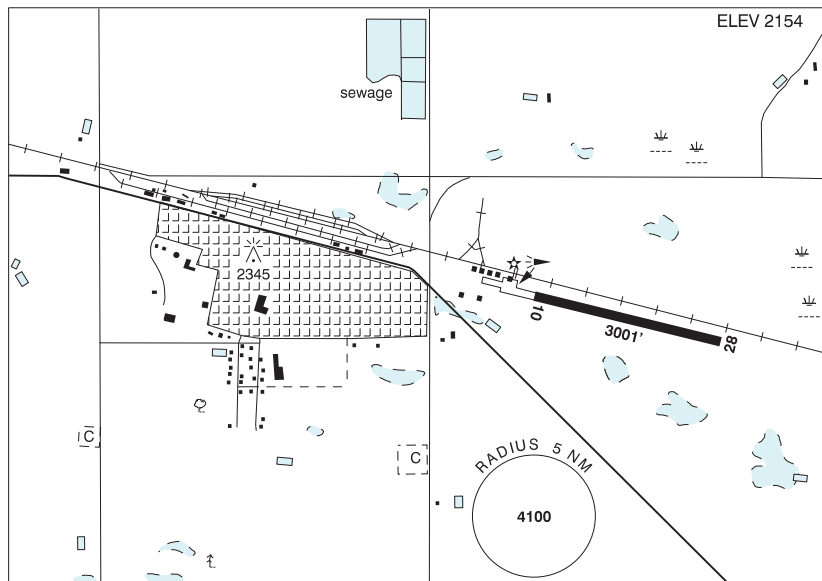

REF	N50 05 57 W102 36 25 8°E (2012) UTC-6 Elev 2154' A5006 LO2 CAP RCAP
OPR	Town 306-736-2515 Reg
PF	C-1,2,4,5
FLT PLN	
FIC	Edmonton 866-WXBRIEF (Toll free within Canada) or 866-541-4102 (Toll free within Canada & USA)
RWY DATA	Rwy 10(096°)/28(276°) 3001x75 ASPH AGN II
RCR	Opr Ocsl delay in snow removal.
LIGHTING	10-(TE LO), 28-(TE LO) ARCAL-123.2 type J
COMM	
ATF	tfc 123.2 5NM 5200 ASL