

## SASKATCHEWAN

## AERODROME / FACILITY DIRECTORY

## KIPLING SK

CKD5

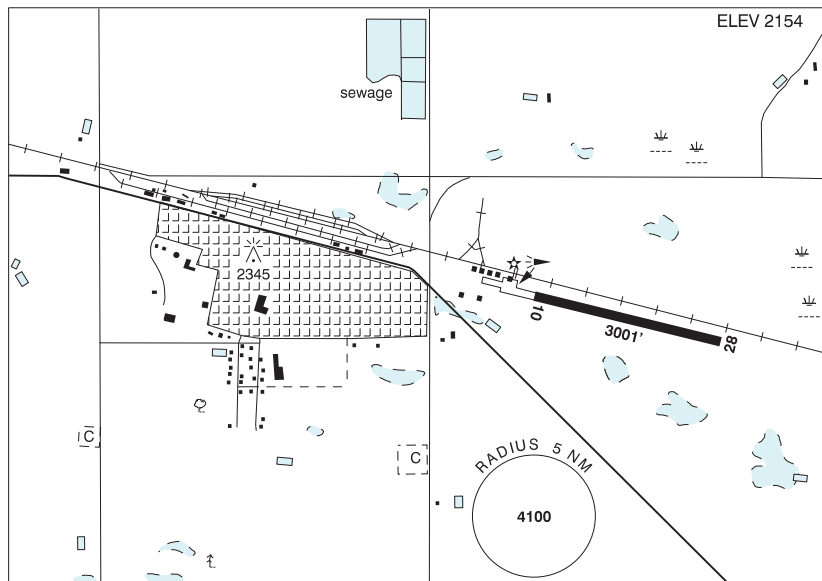

|                 |  |
|-----------------|--|
| <b>REF</b>      | N50 05 57 W102 36 25 8°E (2012) UTC-6 Elev 2154' A5006 LO2 CAP RCAP                            |
| <b>OPR</b>      | Town 306-736-2515 Reg  |
| <b>PF</b>       | C-1,2,4,5  |
| <b>FLT PLN</b>  |  |
| <b>FIC</b>      | Edmonton 866-WXBRIEF (Toll free within Canada) or 866-541-4102 (Toll free within Canada & USA) |
| <b>RWY DATA</b> | Rwy 10(096°)/28(276°) 3001x75 ASPH AGN II  |
| <b>RCR</b>      | Opr Ocsl delay in snow removal.  |
| <b>LIGHTING</b> | 10-(TE LO), 28-(TE LO) ARCAL-123.2 type J  |
| <b>COMM</b>     |  |
| <b>ATF</b>      | tfc 123.2 5NM 5200 ASL   |